

ALLERGY ACTION PLAN

Student's Name: _____ D.O.B: _____ Teacher: _____

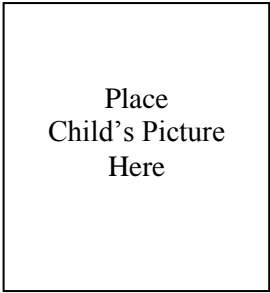

ALLERGY TO: _____

Asthmatic: Yes* No *Higher risk for severe reaction.

◆ **STEP 1: TREATMENT** ◆

Symptoms:

- If a food allergen has been ingested, but *no symptoms*:
- Mouth Itching, tingling, or swelling of lips, tongue, mouth
- Skin Hives, itchy rash, swelling of the face or extremities
- Gut Nausea, abdominal cramps, vomiting, diarrhea
- Throat † Tightening of throat, hoarseness, hacking cough
- Lung † Shortness of breath, repetitive coughing, wheezing
- Heart † Thready pulse, low blood pressure, fainting, pale, blueness
- Other † _____
- If reaction is progressing (several of the above areas affected), give:

Give Checked Medication:**

** (To be determined by physician authorizing treatment)

- | | |
|--------------------------------------|--|
| <input type="checkbox"/> Epinephrine | <input type="checkbox"/> Antihistamine |
| <input type="checkbox"/> Epinephrine | <input type="checkbox"/> Antihistamine |
| <input type="checkbox"/> Epinephrine | <input type="checkbox"/> Antihistamine |
| <input type="checkbox"/> Epinephrine | <input type="checkbox"/> Antihistamine |
| <input type="checkbox"/> Epinephrine | <input type="checkbox"/> Antihistamine |
| <input type="checkbox"/> Epinephrine | <input type="checkbox"/> Antihistamine |
| <input type="checkbox"/> Epinephrine | <input type="checkbox"/> Antihistamine |
| <input type="checkbox"/> Epinephrine | <input type="checkbox"/> Antihistamine |

The severity of symptoms can quickly change. †Potentially life-threatening.

DOSAGE:

Epinephrine: give _____
 medication / dose / route

Antihistamine: give _____
 medication / dose / route

Student may carry and self-administer Epinephrine.

IMPORTANT: Asthma inhalers and/or antihistamines cannot be depended on to replace epinephrine in anaphylaxis.

◆ **STEP 2: EMERGENCY CALLS** ◆

CALL 911 - State that an allergic reaction has been treated, and additional epinephrine may be needed.

EVEN IF PARENT/GUARDIAN CAN'T BE REACHED, DO NOT HESITATE TO MEDICATE OR TAKE CHILD TO MEDICAL FACILITY!

Emergency contacts:

<u>Name / Relationship</u>	<u>Telephone #</u>
----------------------------	--------------------

a. _____ 1) _____ 2) _____

b. _____ 1) _____ 2) _____

c. _____ 1) _____ 2) _____

Doctor _____ at _____

DOCTOR'S SIGNATURE (required) _____ Date _____

PARENT/GUARDIAN (required authorization signature) _____ Date _____



EPIPEN® (EPINEPHRINE) AUTO-INJECTOR DIRECTIONS

1. Remove the EpiPen Auto-Injector from the plastic carrying case.
2. Pull off the blue safety release cap.
3. Swing and firmly push orange tip against mid-outer thigh.
4. Hold for approximately 10 seconds.
5. Remove and massage the area for 10 seconds.

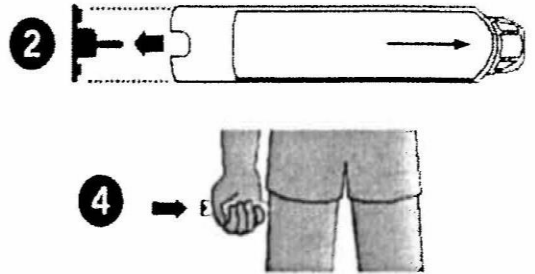

AUVI-Q™ (EPINEPHRINE INJECTION, USP) DIRECTIONS

1. Remove the outer case of Auvi-Q. This will automatically activate the voice instructions.
2. Pull off red safety guard.
3. Place black end against mid-outer thigh.
4. Press firmly and hold for 5 seconds.
5. Remove from thigh.

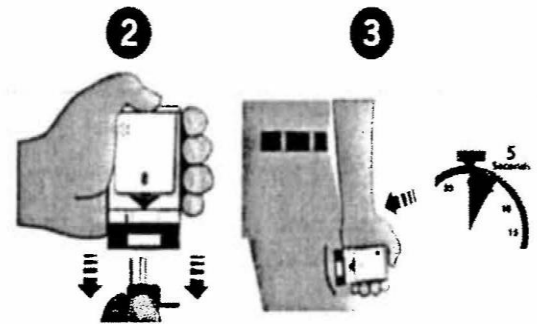

ADRENACLICK®/ADRENACLICK® GENERIC DIRECTIONS

1. Remove the outer case.
2. Remove grey caps labeled "1" and "2".
3. Place red rounded tip against mid-outer thigh.
4. Press down hard until needle penetrates.
5. Hold for 10 seconds. Remove from thigh.

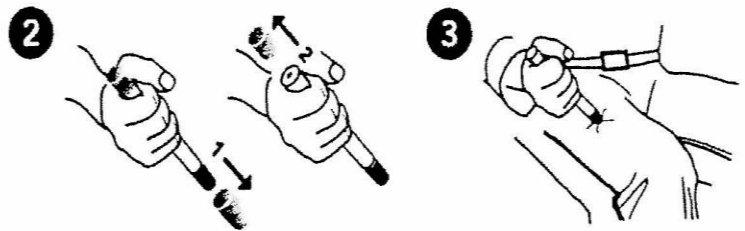

OTHER DIRECTIONS/INFORMATION

Treat student before calling Emergency Contacts. The first signs of a reaction can be mild, but symptoms can get worse quickly.